

THE SMITHS OF ASSABET VILLAGE

ROBERT BARTA

MAYNARD HISTORICAL SOCIETY
MAY 23, 2005

FOUNDING OF SUDBURY AND STOW

SUDBURY C 1676

This map was taken from one drawn by Alfred S. Hudson in his History of Sudbury (1889). It shows the major roads and structures on the west side of the Sudbury settlement at the time of King Philip's War. Courtesy of the Sudbury Town Crier.

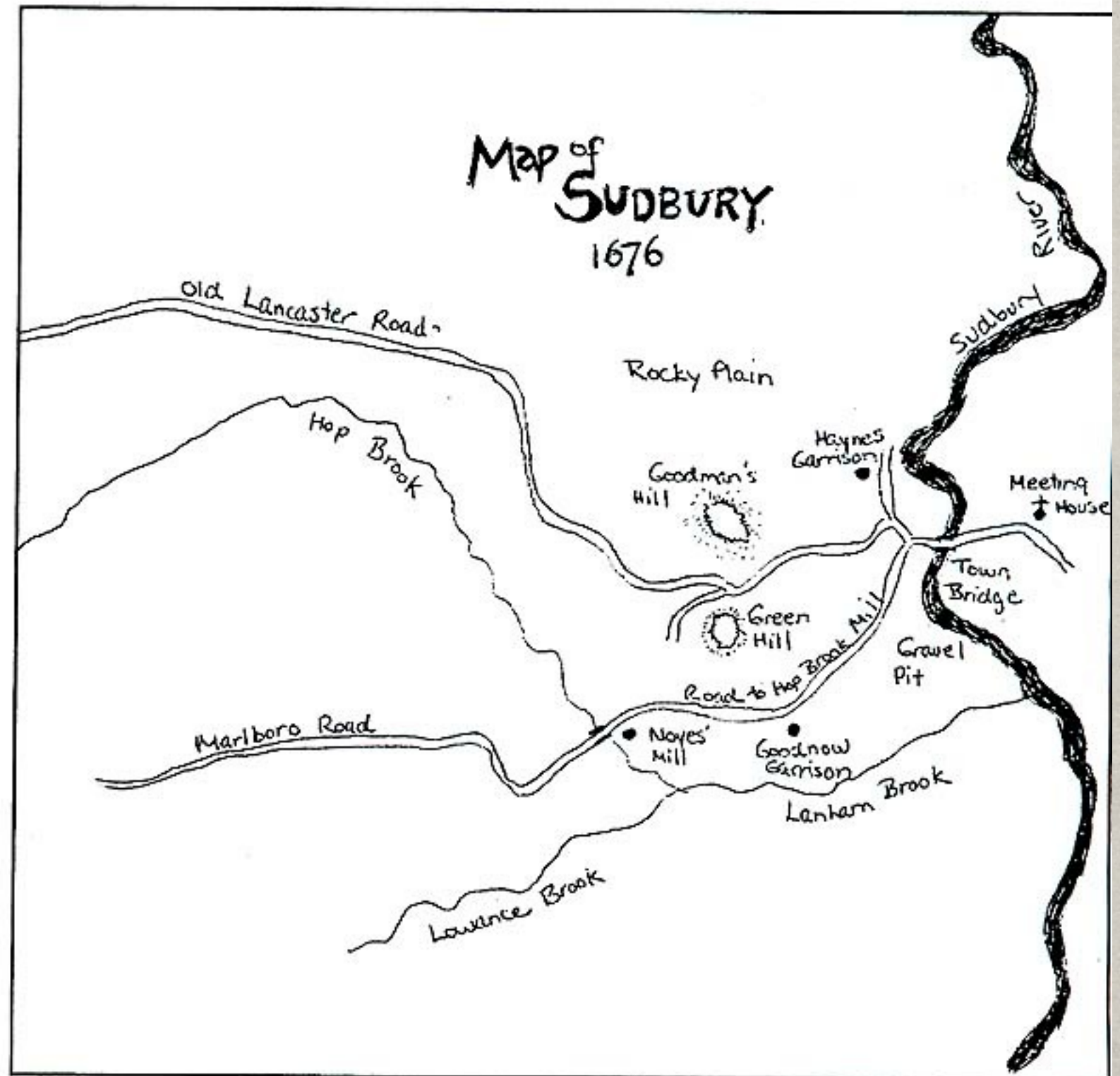

J SMITH LAND GRANT

J. Smith Received Land Grant
of 130 acres in 1658 in Sudbury
Part of Two-Mile Grant. The Two-Mile
Grant was an addition to original five-mile
Grant line.

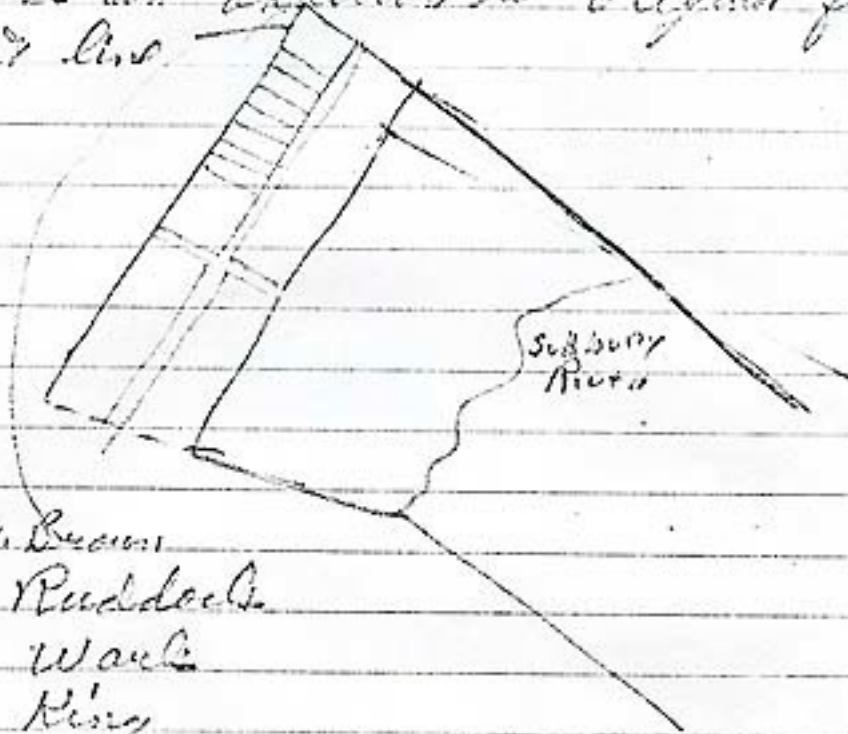

W. Bacon
J. Ruddle
J. Wark
P. King
J. Smith
H. Guilford
H. Rible
J. Riddle
R. Best
W. Kenly
J. Wood

Grant was approximately
1 mile by $\frac{1}{4}$ mile

John Smith full planter
Ante 11. ER.

56/122

GRANT LINES

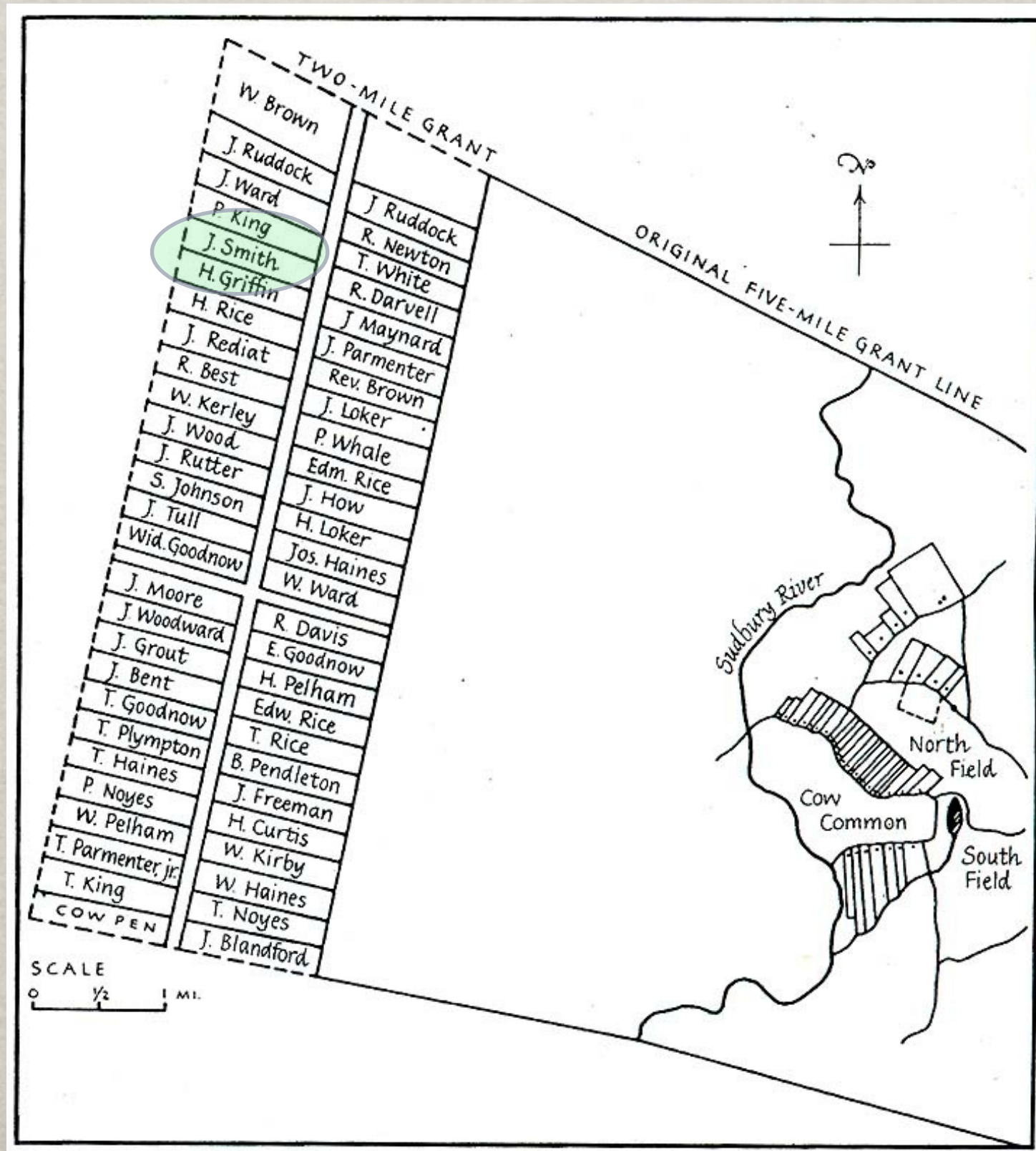

OCCUPANTS OF SUDBURY TOWNSHIP

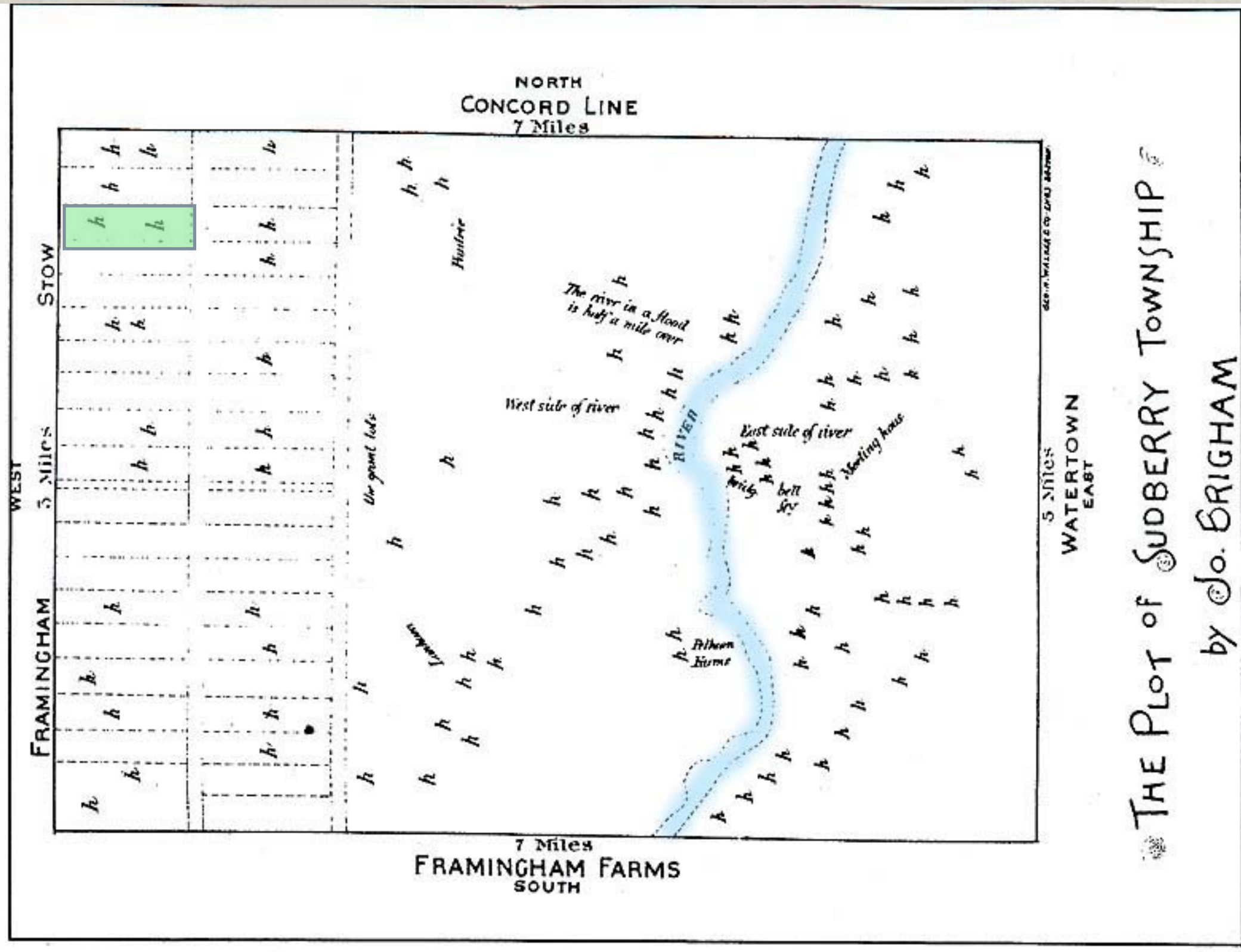

SUDBURY - 1794

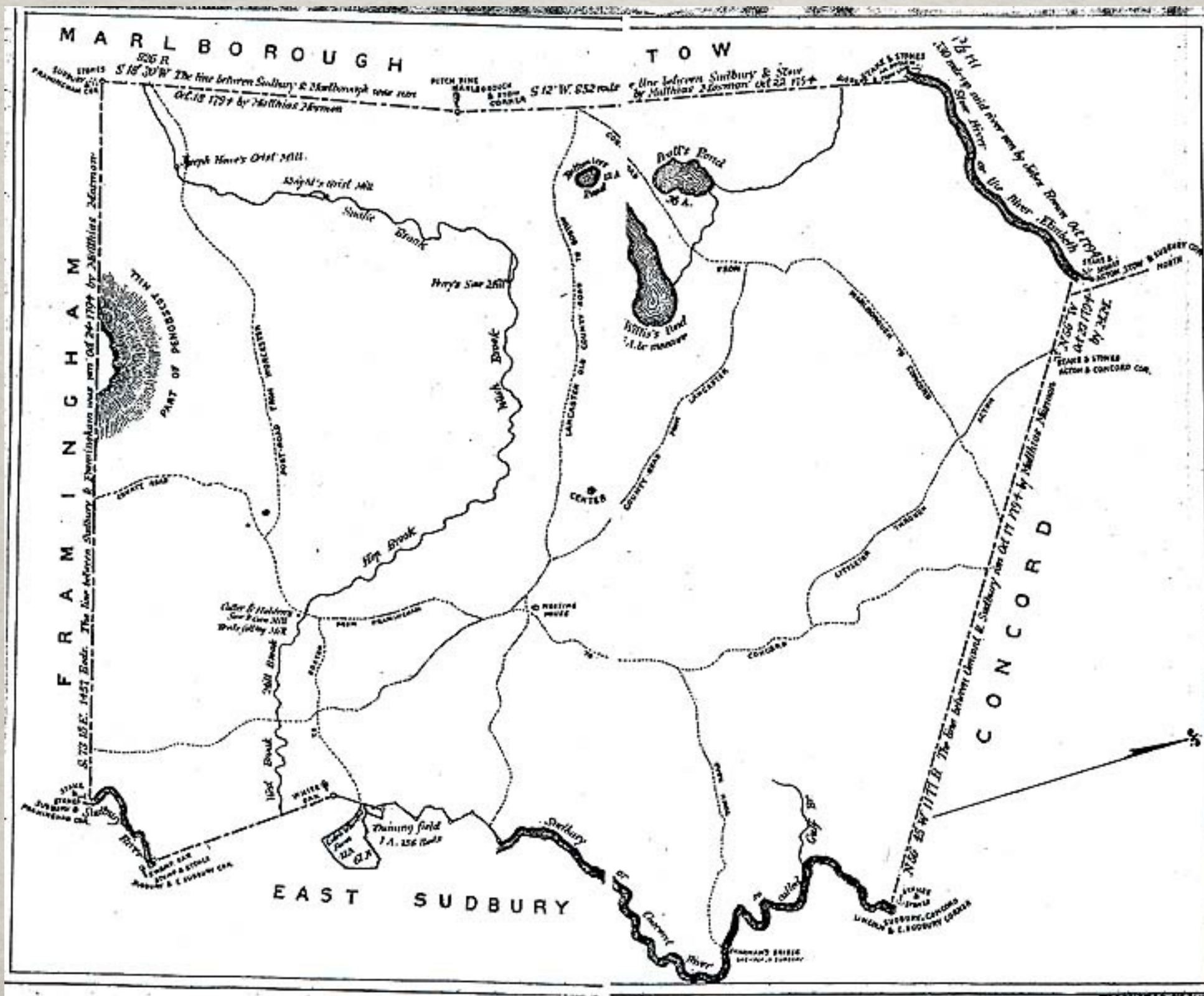

MAYNARD AREA - 1830

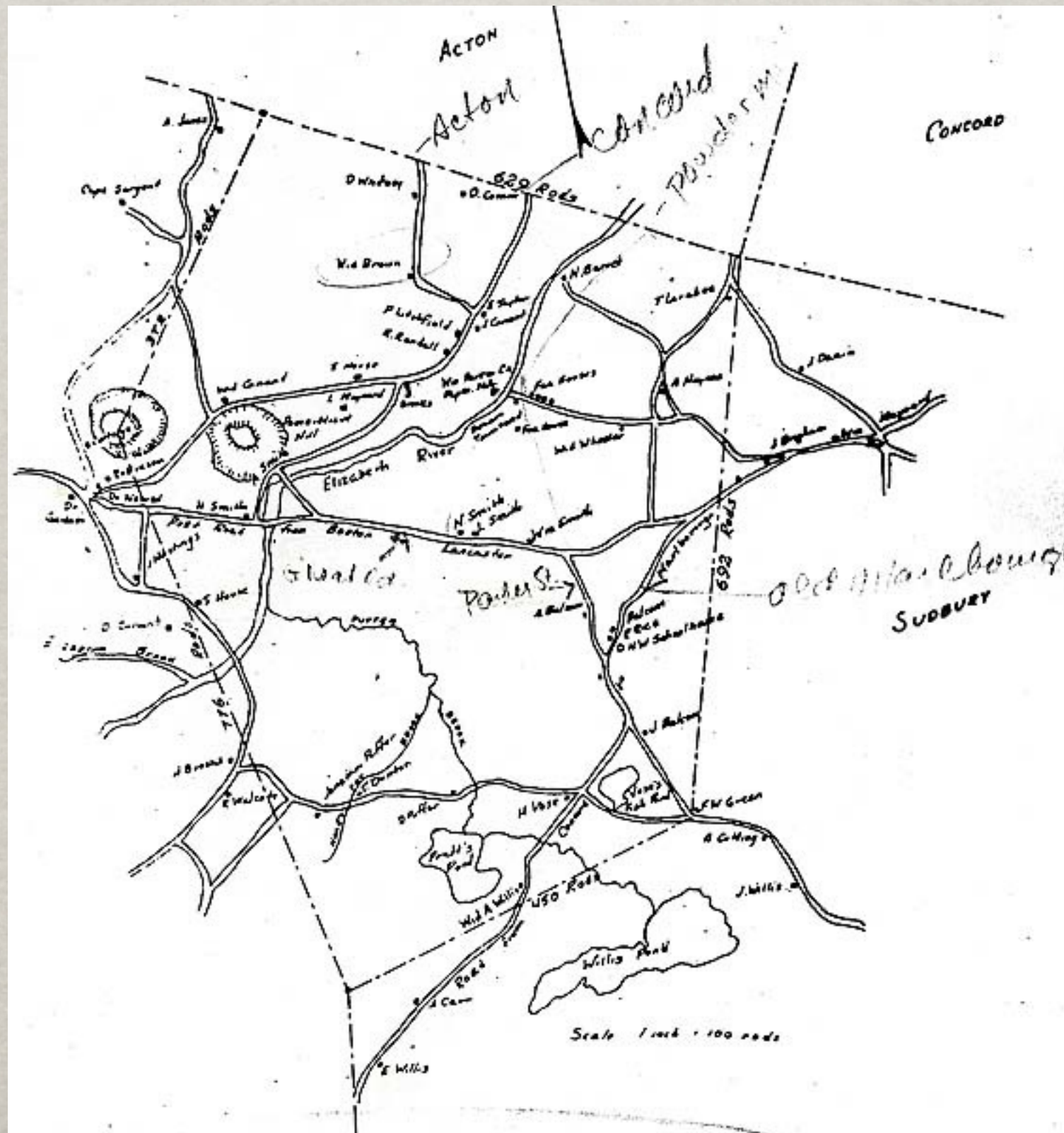

GREAT ROAD - 1830



MAYNARD IN GRANT LINE

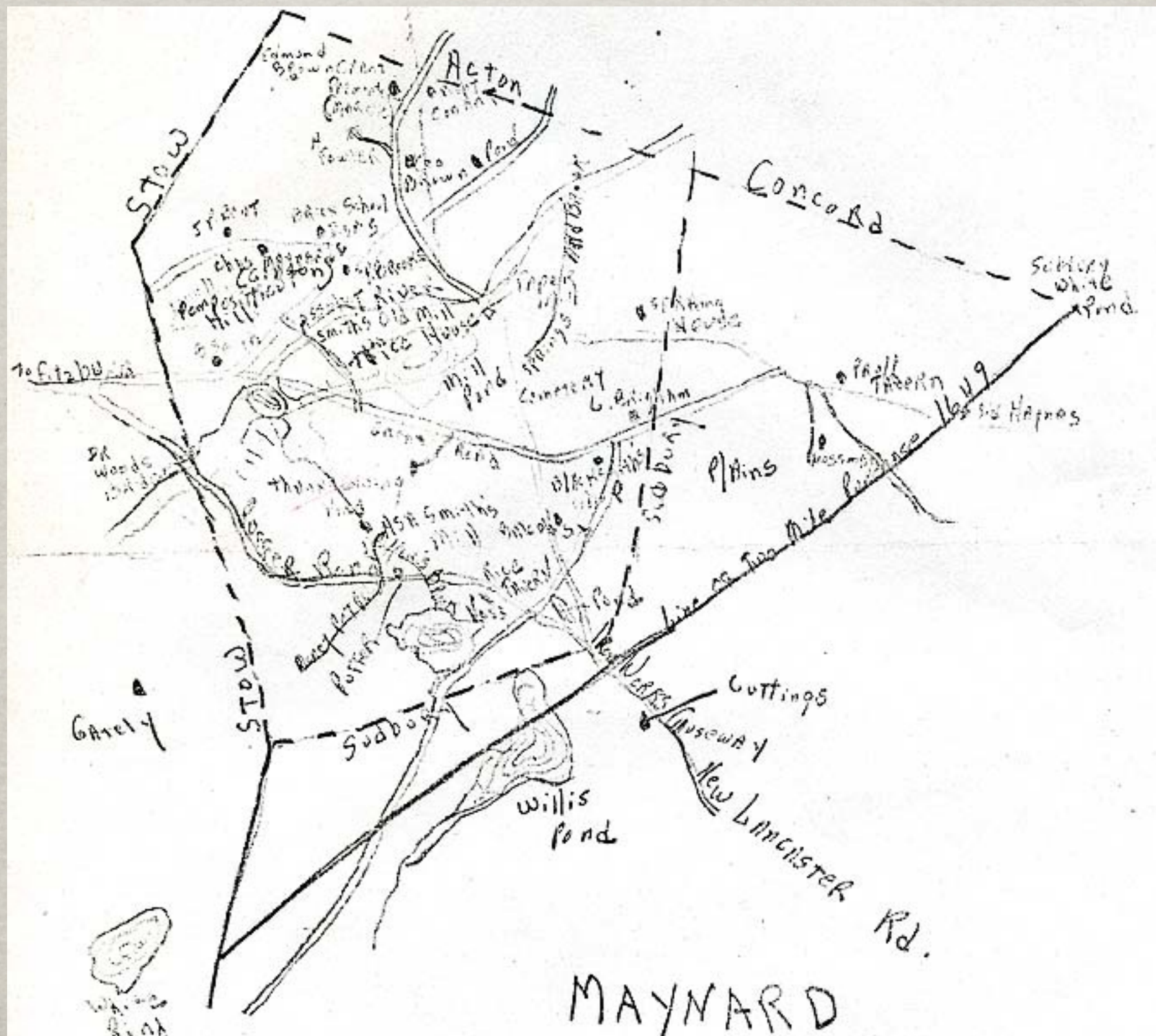

MAYNARD - 1875

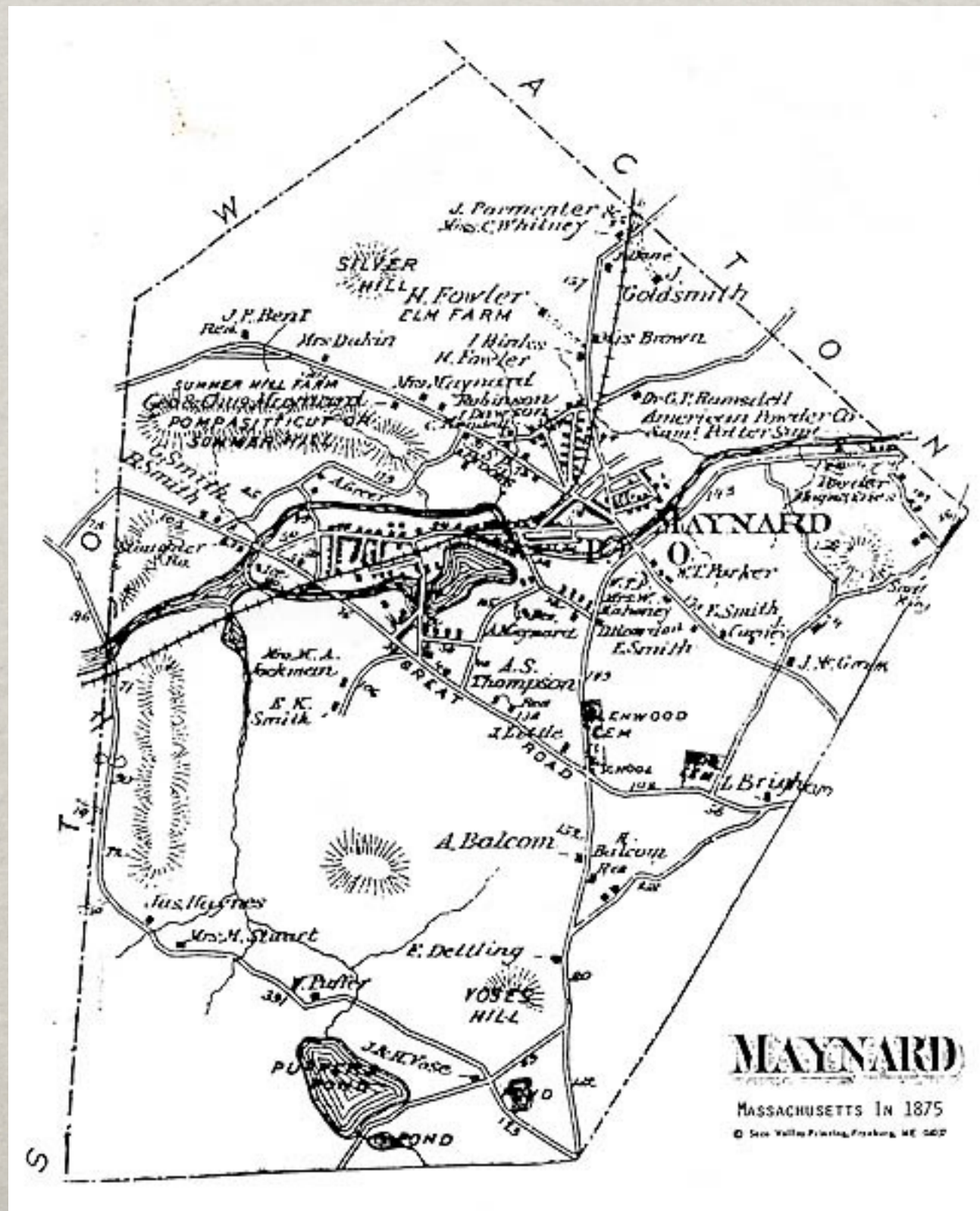

GREAT ROAD - 1875



SMITH FAMILY TREE

SMITH FAMILY TREE

JOHN SMITH FAMILY

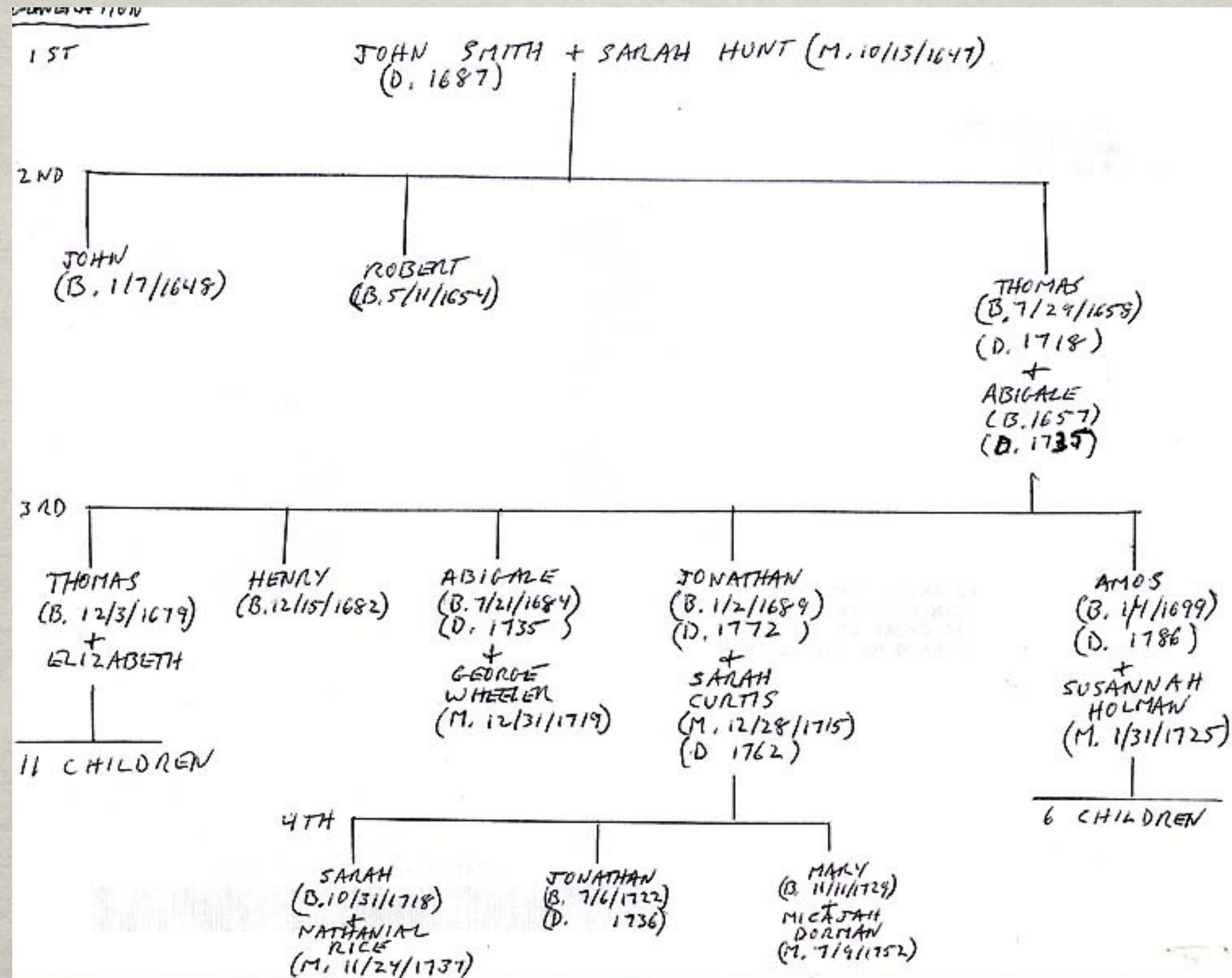

SMITH PROPERTY TRANSACTIONS

HISTORY PERTAINING TO 174 GREAT ROAD, MAYNARD, MASS.

JULY 9, 1645 JOHN SMITH FIRST MENTIONED IN SUDBURY RECORDS
 OCT 17, 1647 JOHN SMITH MARRIED SARAH HUNT
 JAN 4, 1654 JOHN SMITH GIVEN 130 ACRES IN NEW GRANT 29TH LOT 3RD SQUADRON
 JAN 18, 1679 HOUSE HELD BY JOHN SMITH AND THOMAS SMITH ARE INSURED
 JAN 20, 1679 JOHN SMITH + WIFE MARY LIVE TO THOMAS SMITH (SON) 130 ACRES BOUNDED
 NORTH ON NORTH SIDE OF RIVER THENCE TO COMPASSICUT HILL, SOUTH BY HUGH CHIFFIN,
 NORTH BY R. KING, WEST BY HIGHWAY, WEST BY COUNTRY LANDS. (20-157)
 DEC 16, 1684 THOMAS SMITH GIVES THOMAS WARD 20 ACRES OF LAND IN SUDBURY AND 12 IN STW
 FOR 40 ACRES IN SUDBURY BOUGHT FROM T. WARDEN AND PERMISSION TO CUT
 CLAY FROM WARD FORD TO RETURN SMITH HOUSE. LEAD TO BE BUILT BEYOND
 NORTH BY SMITH HOUSE (4-277)
 JAN 23, 1699 THOMAS SMITH PURCHASE FROM J. BANISTER FOR 500 POUNDS 100 ACRES FORMERLY
 OWNED BY DECEASED JOHN RUDOLPH (20-151)
 DEC 17, 1700 THOMAS SMITH PURCHASE FROM J. RICE FOR 15 POUNDS 100 ACRES FORMERLY
 30 ACRES BOUNDED WEST + SOUTH BY J. RICE, NORTH BY J. FROSTMAN, STW BY THOMAS (SON)
 JAN 5, 1715 THOMAS SMITH PURCHASE FROM HAYNES 6 ACRES FOR 9 POUNDS 10 SHILLINGS (20-152)
 JAN 11, 1715 THOMAS SMITH LIVES TO JONATHAN SMITH (SON) 130 ACRES BEING THE WESTERN HALF
 OF THE 2 NEW GRANT LOTS PLUS 5 ACRES IN IRON WORK MOW (25-603)
 MAY 13, 1715 THOMAS SMITH LIVES TO THOMAS SMITH JR. (SON) 100 ACRES BEING FORMERLY
 THE PROPERTY OF DECEASED JOHN RUDOLPH 2ND SQUADRON 29TH LOT (20-252)
 AUG 26, 1718 THOMAS SMITH SELLS TO JONATHAN SMITH (SON) 1/2 OF IRON WORK MOW IN
 N.W. SIDE OF SUDBURY RIVER FOR 10 POUNDS 10 SHILLINGS (20-178)
 NOV 20, 1717 THOMAS SMITH WIFE (D. 1719) LEAVES THE OTHER HALF OF IRON WORK MOW
 TO JONATHAN (SON) AND HIS OTHER LAND AND HOUSE TO AMES SMITH (SON)
 WITH OTHER CHILDREN CUTTING MERRY. (OTHER LAND MUST BE 130 ACRES
 IN THE WESTERN HALF OF THE 2 NEW GRANT LOTS.)
 JAN 7, 1723 JONATHAN SMITH PURCHASE FROM J. TOWER 1/4 ACRES N.W. OF ASSETT A MOW
 WITH APPURTENANCES FOR 10 POUNDS (59-585)
 NOV 23, 1737 AMES SELLS TO DAVID MAYNARD 4 1/2 ACRES LOWER GOLF MOW FOR 45 POUNDS
 (44-41)
 AUG 3, 1738 JONATHAN SELLS TO JOHN TOWER OF STW THE RIGHT TO TRAVEL ON THE ASSETT
 RIVER, BUILD A DAM AND RAISE THE FINE FARM, AND A HOUSE.
 NOV 25, 1750 SMITH FAMILY BUYS FROM SKIMMER, LAND FOR A SCHOOL HOUSE FOR 5 SHILLINGS (STW)
 DEC 26, 1763 AMOS SMITH + BENJAMIN SMITH (SON) BUY FROM TAYLOR (MUCH) LAND BOUNDED
 WEST BY JONATHAN, NORTH BY AMOS, AND EAST BY PUFFER FOR 53 POUNDS
 6 SHILLINGS AND 8 PENCE (61-329)
 MAR 27, 1765 AMES SMITH SELLS TO BENJAMIN SMITH (SON) FOR 120 POUNDS 55 ACRES COMPOSED OF
 1. 1/4 ACRES 4000, 2. 45 ACRES WEST OF DAM, 3. 1/2 OF IRON WORK MOW, 4. ONE
 ACRES WEST OF OLD LANDING. ALSO OTHER HALF OF HOUSE + SOUTH HALF OF GOLF
 (65-619)
 DEC 15, 1766 JONATHAN SMITH SELLS TO ELIZABETH SMITH (NEPHEW?) 300 ACRES BOUNDED NORTH AND
 WEST BY RIVER AND EAST BY BENJAMIN SMITH FOR 70 POUNDS (81-195) (10-1711)
 FEB 4, 1768 AMOS SMITH SELLS TO BENJAMIN 130 ACRES INCLUDING DAM, CERN DAM, DWELLING
 HOUSE + LORN-TO FOR 200 POUNDS (69-320)
 FEB 4, 1768 AMOS SMITH SELLS TO JONATHAN SMITH (SON) 10 ACRES LAND EAST OF ROAD + 1/2 ACRES IN
 IRON WORK FOR 100 POUNDS (81-111)
 FEB 4, 1768 BENJAMIN SELLS TO JONATHAN 40 ACRES + LAND WEST OF FENCE + 1/2 ACRES ABOVE
 THE ORCHARD FOR 40 POUNDS (83-166)

MAR 15, 1777 BENJAMIN PURCHASE FROM T. HALE 75 ACRES AND A HOUSE FOR 400 POUNDS (77-483)
 JULY 15, 1777 AMOS SELLS TO J. PUFFER 2 ACRES FOR 30 POUNDS (87-282)
 FEB 7, 1782 JONATHAN PURCHASE FROM J. STALL 8 ACRES INCLUDING STW FOR 60 POUNDS (81-194)
 MAY 7, 1782 JONATHAN PURCHASE FROM W. RICE 27 ACRES FOR 100 POUNDS (83-164) (83-167)
 1784 JONATHAN PURCHASE FROM WILLIS 12 1/2 ACRES FOR 70 POUNDS (86-503)
 JAN 10, 1785 BENJAMIN PURCHASE FROM C. HAYNES HOUSE + LAND FOR 130 POUNDS (87-532)
 APR 13, 1785 BENJAMIN PURCHASE OF LAND IN SUDBURY (100-500)
 1785 BENJAMIN PURCHASE FROM ELIZABETH SMITH 17 ACRES FOR 25 POUNDS 10 SHILLINGS (100-167)
 JAN 22, 1785 JONATHAN PURCHASE FROM J. WOOD 6 1/2 ACRES NORTH STW A. FOR 35 POUNDS (117-210)
 1787 JONATHAN PURCHASE FROM BENJAMIN 17 ACRES + HOUSE SOUTH OF OLD MARLBOROUGH RD FOR 140 POUNDS (125-271)
 1787 JONATHAN PURCHASE FROM HAYNES 13 ACRES FOR 217.33 (125-273)
 MAY 10, 1789 JONATHAN PURCHASE FROM PUTMAN 11 ACRES IN STW FOR 1800 (132-306)
 APRIL 2, 1801 JONATHAN PURCHASE FROM J. WOOD 7 1/2 ACRES BY STW A. FOR 175.50 (135-414)
 1807 BENJAMIN PURCHASE FROM J. SMITH 10 ACRES IN SUDBURY + STW WITH BLOKS. AND
 DWELLING HOUSE FOR 233.33 WITH WATER LIVER WITH AUTUMN (175-30)
 MAR 7, 1801 BENJAMIN SELLS TO JEDIDIAH SMITH (SON) THE HAYES PROPERTY (BOUGHT WHITES) FOR 243 POUNDS
 6 SHILLINGS (232-475)
 DEC 17, 1801 BENJAMIN SELLS TO WILLIAM SMITH (SON) 120 ACRES (BOUGHT WHITES) FOR 966.66 (242-212)
 1803 BENJAMIN SELLS TO E. SMITH (SON?) 110 ACRES FORMERLY IN N.W. ACRES (107-293)
 SEPT 14, 1804 JONATHAN SELLS TO ASA FROST 5 ACRES FOR 90 (179-229)
 MAY 1, 1805 JONATHAN SELLS TO JEDIDIAH SMITH 3 ACRES NORTH IRON WORK NORTH DAM WITH LIBERTY
 FOR BENT TO PASS FOR 331 (185-119)
 JUNE 22, 1805 BENJAMIN SELLS TO ANTHONY (SON) TAYLOR LAND (BOUGHT 2/17/1803) + 2 ACRES IN IRON WORK
 FOR 530 (294-301)
 JULY 2, 1810 JONATHAN SELLS TO LEVI (SON) 120 ACRES + DAMS (BOUGHT 2/17/1803) FOR 511 (190-325)
 FEB 18, 1811 JONATHAN SELLS TO NATH (SON) 6 1/4 ACRES SOUTH OF PETERS FIELD FOR 900 (226-140)
 FEB 24, 1812 BENJAMIN SELLS TO WILLIAM 8 ACRES FOR 81 (249-13)
 DEC 21, 1812 BENJAMIN SELLS TO ASH (SON) 12 ACRES + HOUSE + DAM IN STW WITH PRIVILEGE TO LIVE IN
 THE WESTERN HALF FOR 900 (203-112)
 JAN 23, 1813 BENJAMIN SELLS TO HANNAH (SON) 10 ACRES FORMERLY (BOUGHT 1801) FOR 1400 (207-334)
 MAR 4, 1814 JONATHAN SELLS TO J. HAYNES 40 ACRES INCLUDING PLAGE FOR 500 (232-61)
 SEPT 21, 1814 NATH PURCHASE FROM BENJAMIN 5 1/2 ACRES NORTH WILLIS HILL FOR 974 (226-141)
 MAY 29, 1815 NATH PURCHASE FROM CHAR 5 ACRES SOUTH OF ROAD FOR 850 (210-408)
 JUNE 17, 1815 LEVI PURCHASE FROM PARSONS 27 1/4 ACRES BY STW FOR 911 (224-225)
 JAN 13, 1817 J. SMITH SELLS TO HOWE ESTATE OF DAVID HOWE SR FOR 2310 (237-85)
 APR 15, 1817 NATH PURCHASE FROM JONATHAN 14 ACRES FOR 375 (226-142)
 JUN 16, 1817 LEVI PURCHASE FROM JONATHAN 3 ACRES BY CERN DAM TO HUNTING HILLS NORTH J. BARKS
 FOR 95 (267-143)
 APR 11, 1819 NATH PURCHASE FROM RICE 40 ACRES FOR 700 (226-143)
 AUG 15, 1819 NATH PURCHASE FROM WILLIS 80 ACRES FOR 275 (226-144)
 SEP 27, 1819 JONATHAN SELLS TO NATH 5 ACRES WITH 2 ACRES ORCHARD FORMERLY OWNED BY BENJAMIN
 FOR 1100 (226-146)
 MAY 22, 1822 LEVI PURCHASE FROM WILLIAM 3 ACRES PETER FIELD N.W. BY LAD WAY S. BY HANNAH C. BY LEVI
 FOR 35 (259-141)
 JAN 2, 1821 LEVI PURCHASE FROM HANNAH 20 ACRES THENCE FOR 450 (263-444)
 MAR 16, 1822 NATH SELLS TO BALCOM 90 ACRES CERN FIDUCIARY TO NATH FOR 337.90 (241-444)
 JAN 19, 1822 WILLIAM PURCHASE FROM L. BARKS + SONS 3 ACRES PETER FIELD 8 ACRES IRON WORK MOW
 S. BY EDWARD RICE, EAST BY A. SMITH, N.W. BY CPT JEDIDIAH SMITH (249-16)
 AUG 20, 1825 NATH PURCHASE FROM BALCOM 14 ACRES + HOUSE FOR 850 (262-151)
 1822 NATH PURCHASE FROM JEDIDIAH 16 ACRES FOR 266 (242-241)

SMITH PROPERTY TRANSACTIONS

MAR 18, 1825	NORRIS PURCHASE FROM ADAMS 4 ACRES + HOUSE FOR \$300 (268-289)
SEPT 6, 1825	NORRIS PURCHASE FROM WILLIS 4 ACRES BY WILLIS HILL FOR \$9.50 (268-290)
MAY 16, 1826	NORRIS PURCHASE FROM PARMENTER WILLIS LAND + HOUSE FOR \$350 (268-291)
SEPT 18, 1826	NORRIS SELLS TO I. RICE 41 ACRES BY DALCOM, BRIGHTON + BOWEN FOR \$100 (271-271)
FEB 26, 1827	NORRIS PURCHASE FROM GOODNOW 60 ACRES FOR \$1040.50 (282-455)
MAR 12, 1828	LEVI SELLS TO WILLIAM TR. 3/4 ACRE WEST OF WILLIAM BOUNDARY BY TOWN WAY AND COUNTY ROAD FOR \$12.50 (302-247)
FEB 17, 1834	NORRIS SELLS TO J. PARMENTER 16 ACRES ON SW SIDE OF WILLIS HILL WITH RIGHT TO PASS FOR \$288 (332-276)
FEB 17, 1834	NORRIS SELLS TO J. WILLIS 10 ACRES ON SW SIDE OF WILLIS HILL. SW CORNER IS ON LANCASTER ROAD FOR \$162 (333-432)
1834	NORRIS PURCHASE FROM WILLIS 10 ACRES FOR \$100 (333-433)
1844	NORRIS WILLIS TO RUTH 2 ACRES + BLOKS WITH HOMESTEAD WORTH \$900
	RUTH SELLS TO A. THOMPSON LAND (\$24-266-4)
	RUTH SELLS TO A. THOMPSON LAND NEAR VOSE (644-263)
JUNE 26, 1852	G. GOODNOW } SELLS TO A. THOMPSON HOUSE + 2 ACRES + 6 ACRE POTTERS FIELD E. GRIFFITH } FOR \$1300 (679-22) A. SMITH } (HOMESIDE RUTH SMITH)
1884	A. THOMPSON WILLS HOUSE TO WIDOWER SON-IN-LAW WM. EVELETH AND 2 GRANDCHILDREN, CHARLES + FLORENCE. \$1100 VALUE (23780)
OCT 12, 1922	WILLIAM EVELETH WILL, CHARLES WIDOW, CHARLES ^{CATHARINE} + CATHARINE ^{FLORENCE} HAVE AND SOLD HOUSE TO ALICE L. RAPSON JAN 23, 1925 (4804-244)
1936	ALICE A. L. RAPSON WILLS HAVE HOUSE TO ELIZABETH BROWN EVELETH DAY (NORRIS)
MAY 18, 1936	E. DAY SELLS TO D. P. LITTLEFIELD FOR \$3300 (6042-324)
OCT 14, 1943	LITTLEFIELD SELLS TO JAMES E. O'HETH (6715-545)
OCT 20, 1943	O'HETH SELLS TO MATTHEW T. KING FOR \$3,000 (6721-302)
APR 30, 1946	KING SELLS TO VIRGINIA N. ROBINSON FOR \$6,000 (7001-415)
JUNE 27, 1960	ROBINSON SELLS TO HAROLD H. SHAW 9,000 (9623-147)
DEC 3, 1973	SHAW SELLS TO ROBERT M. BANTA 56,000 (125-81-654)

A MYSTERY SOLVED?

Year	Who	Acres	House	Cost
1777	Ben	75	1	400
1782	Jon	86		60
1782	Jon	27	?	100
1784	Jon	12-3/4		76
1785	Ben	?	1	138
1789	Ben	?	?	?
1791	Ben	?		6.5
1791	Jon	13		26.12
1793	Jon	6-3/4		35
1797	Jon	17	1	148
1797	Jon	29	?	217
1799	Jon	110	?	1800
1800	Jon	7-1/2		124
1800	Ben	120	1+	2333

A MYSTERY SOLVED?

Benjamin and Jonathan Smith
(sons of Amos Smith) bought 14
properties in 24 years (without
selling any) consisting of about 600
acres and 8 houses for about \$6300

In today's dollars that would be \$3.1 million.

JOHN SMITH FAMILY

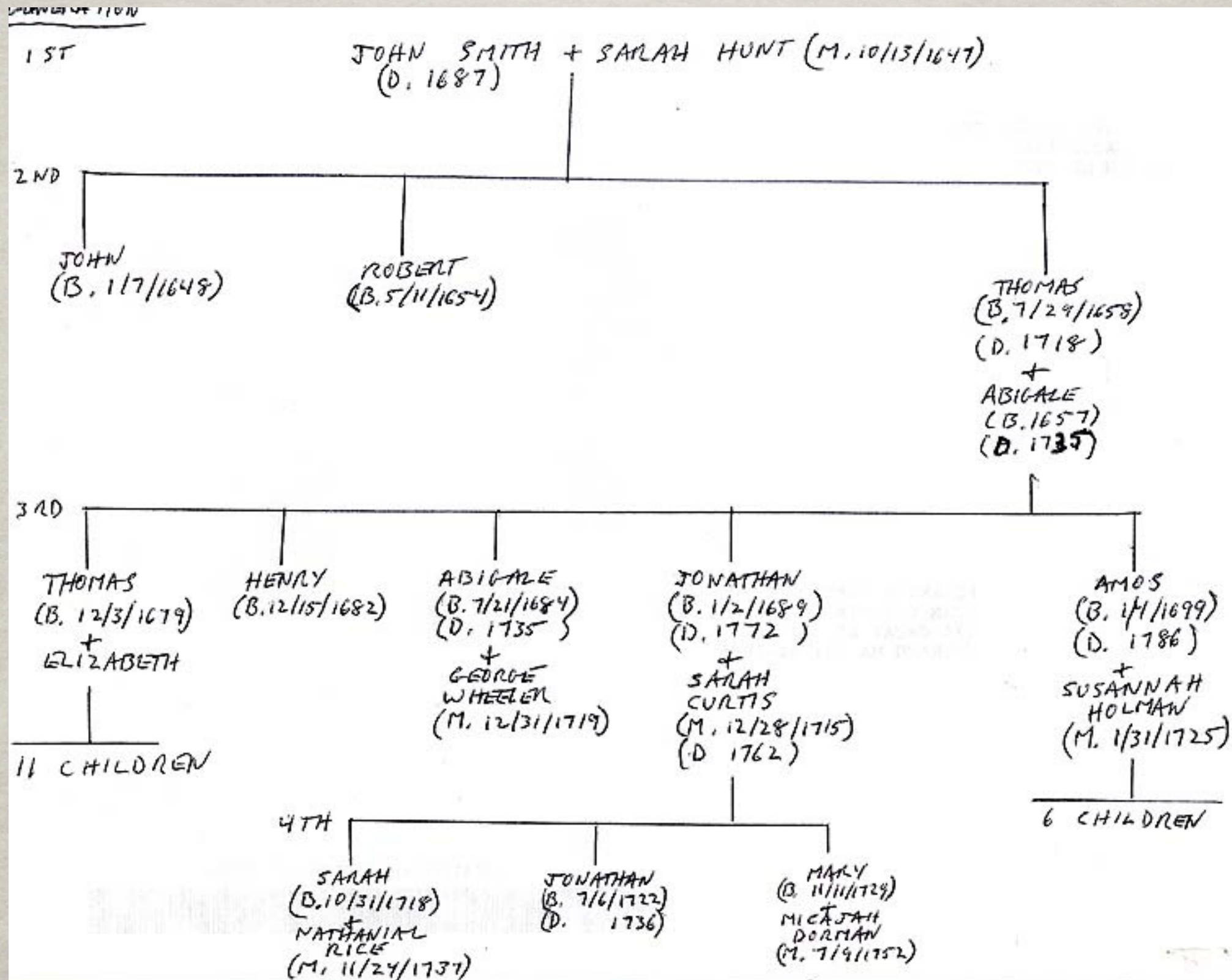

THOMAS SMITH FAMILY

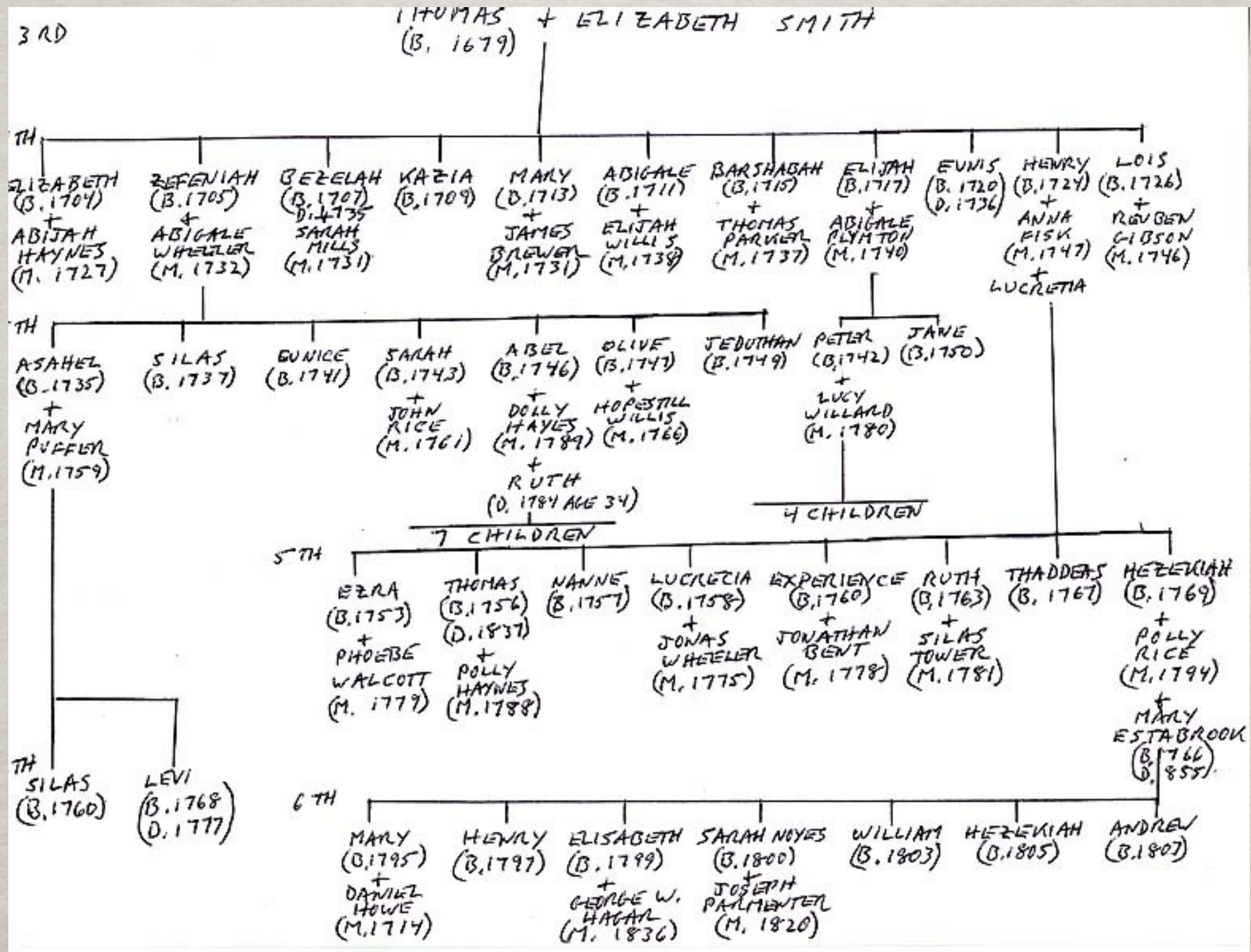

ABEL SMITH FAMILY

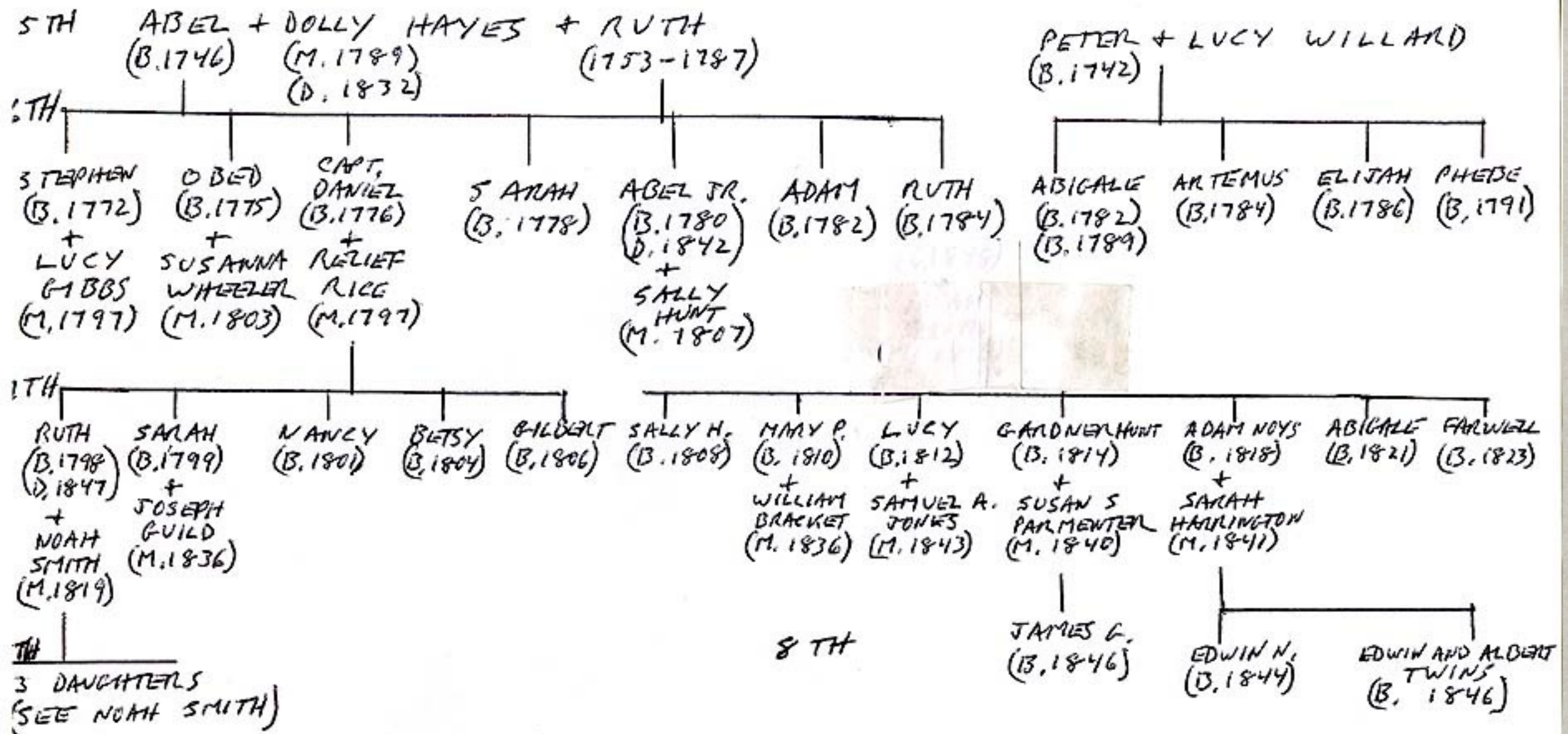

AMOS SMITH FAMILY

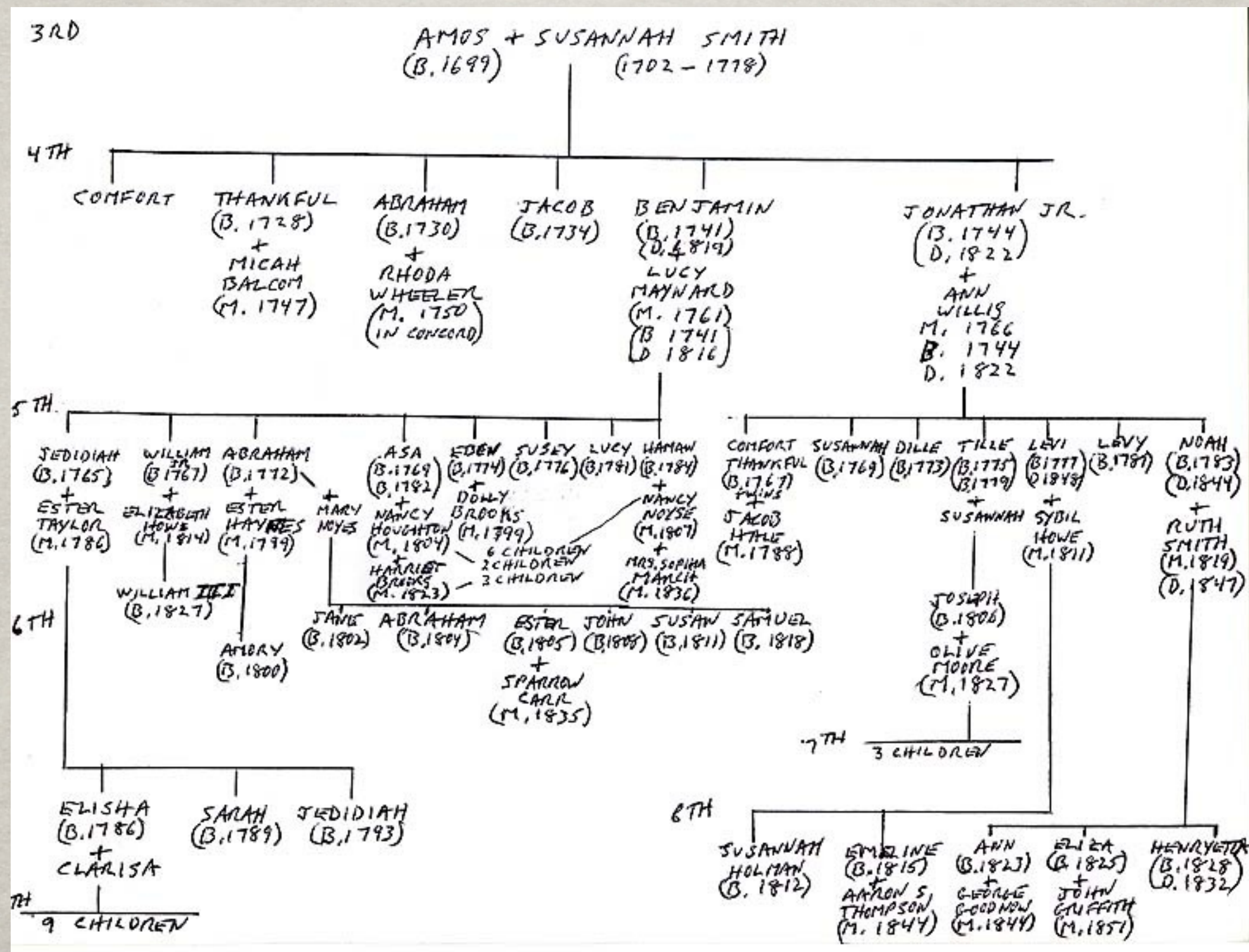

ASA SMITH FAMILY

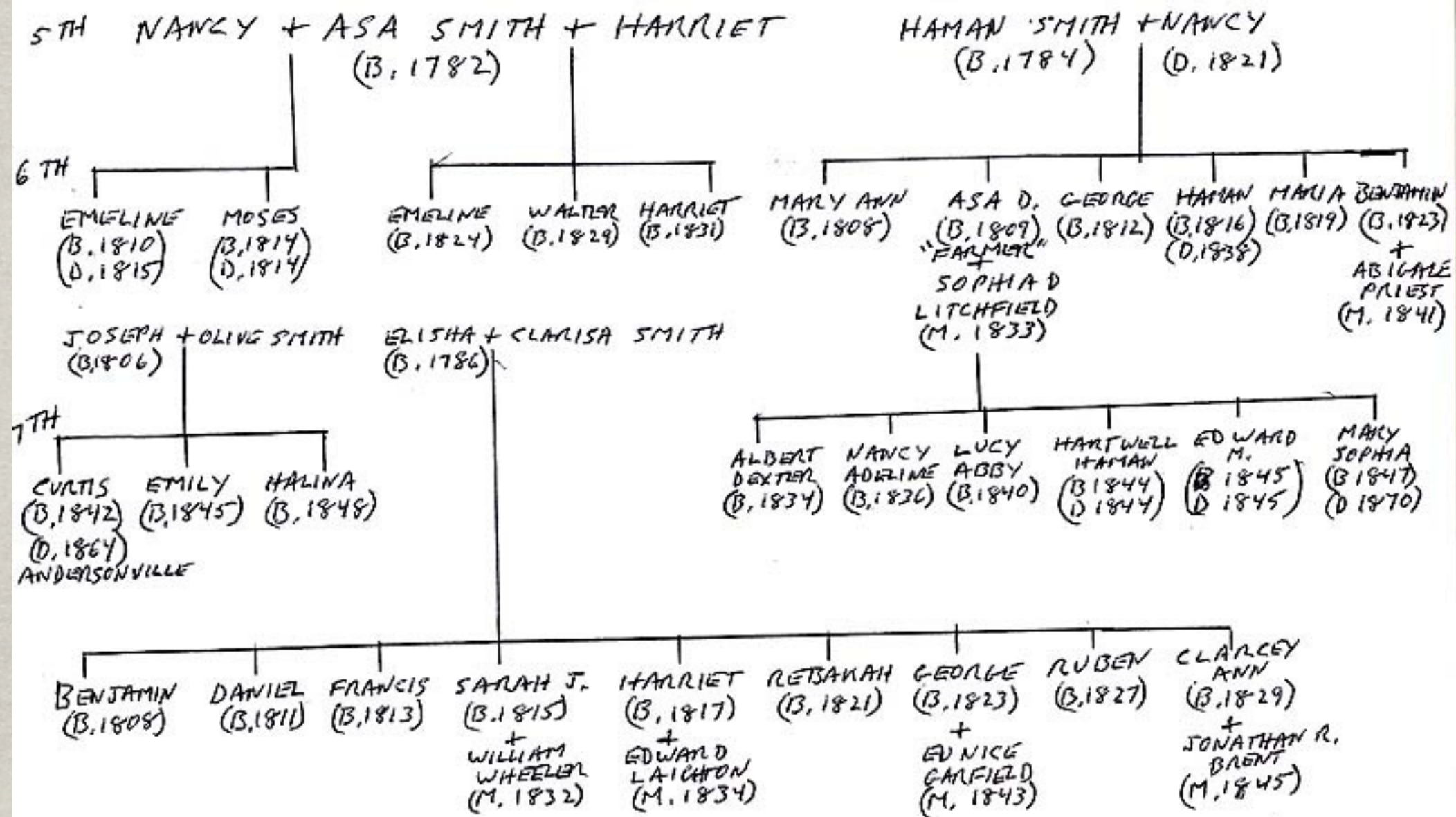

WHERE WERE
THEY THEN?



NOAH SMITH
174 GREAT ROAD



LEVI SMITH
178 GREAT ROAD



WILLIAM SMITH
206-208 GREAT ROAD



CIDER MILL
176 GREAT ROAD



SUSAN SMITH SCHOOLHOUSE
176 GREAT ROAD



HAMAN SMITH
36 GREAT ROAD



GEORGE SMITH
38 GREAT ROAD



ASA SMITH
84 SUMMER HILL ROAD

174 GREAT ROAD SUMMARY

JOHN SMITH	D 1687	HAD HOUSE IN 1678
THOMAS SMITH	1658-1718	HAD HOUSE IN 1678 GAVE BY WILL TO AMOS
AMOS SMITH	1699-1786	AMOS SOLD $\frac{1}{2}$ HOUSE TO BENJAMIN
BENJAMIN SMITH	1741-1819	AQUIRED OTHER $\frac{1}{2}$ HOUSE
JONATHAN SMITH	1744-1822	RETURNED FROM TOWN OF PRINCETON FOR AN ODD 3-WAY TRANSACTION BETWEEN HIS BROTHER BEN AND FATHER AMOS IN 1788 ON THE SAME DAY WITH OFFICIAL REGISTRATION OF THE 3 DEEDS 900 MIDDLESEX COUNTY COURTHOUSE OCCURRING OVER A 15 YEAR PERIOD.
NOAH SMITH	1783-1844	BOUGHT 39 ACRES FROM JONATHAN FOR 7000 WITH 2 ACRES BEING SURROUNDED BY LAND OF BROTHER LEVI IN 1818
RUTH SMITH	1798-1847	INHERITED ^{2 ACRES} HOMESTEAD ^{WORTH 900} OF HUSBAND AND WILLED IT TO 2 DAUGHTERS AND SON-IN-LAW

174 GREAT ROAD SUMMARY

HEINS OF RUTH SMITH	1852	SOLD TO LEVI'S SON-IN-LAW
AARON THOMPSON	D. 1888	AARON THOMPSON PLUS ACRES FOR \$1300
		WILLS 2 FAMILY TENEMENT HOUSE TO
		WIDOWER SON-IN-LAW AND 2 GRANDCHILDREN
		CHARLES + FLORENCE 1100 VALUE
WM EVELLETH	D 1922	WILL PLUS CHARLES WIDOW AND FLORENCE
		GAVE + SOLD HOUSE TO HIS SECOND WIFE'S
		DAUGHTER BY A PREVIOUS MARRIAGE,
		ALICE RAPSON IN 1925
ALICE RAPSON	D 1936	WILL GAVE HOUSE TO MRS. ELIZABETH
		BROWN EVELLETH DAY, ADOPTED DAUGHTER
		OF HER NATURAL GRANDFATHER, WM
		EVELLETH.

ELIZABETH DAY	1936	SOLD TO D.P. LITTLEFIELD FOR \$3300
LITTLEFIELD	10-14-1943	SOLD TO JAMES F. O'HEA
O'HEA	10-20-1943	SOLD TO MATTHEW T. KING FOR \$3,000
KING	1946	SOLD TO VIRGINIA ROBINSON FOR \$6,000
ROBINSON	1960	SOLD TO HAROLD SHAW FOR \$9,000
SHAW	12-3-1973	SOLD TO ROBERT (+JOAN) BANTA FOR \$56,000

LETTERS FROM THE PAST

WHERE ARE THEY
NOW?

STOW LOWER CEMETERY

1718	Thomas, 59
1735	Abigale, wife, 79
1736	Jonathan, grandson, 15
1777	Levi, 9
1861	Asa Dexter, 53
1886	Sophia, wife, 75
1844	Hartwell, 1 month
1843	Edward, 1 month, 13 days
1870	Mary, 23

SUDBURY BURIAL GROUND

Monument: Buried here John Smith and Sarah his wife first ancestors from Sudbury, England 1658

- Erected by Mrs. Sarah S. Jones, one of the sixth generation

1779	Abraham, 10, son of Ben & Lucy
1793	Benjamin, 21 days, son of Ben & Lucy
1801	Jedediah, 11
1837	Thomas. 81
1787	Ruth, 31, wife of Abel

SUDBURY BURIAL GROUND

1822	Jonathan, 78
1822	Ann, 78, wife
1844	Noah, 60, son Jonathan and Ann
1842	Ruth, 49, wife
1832	Henryetta, 4, daughter of Noah and Ruth
1830	This stone marks the spot where rests the body of Mrs. Nancy, wife of Mr. Charles Barnes, of Lowell, who died in the house of Mr. Levi Smith, June 15, 1830 aged 29 years, 1 month, and 1 day.

A STORY OF REGICIDE

THE FOUNDING OF MAYNARD

- ✻ 1871 - Maynard Founded
- ✻ 1900 Acres from Sudbury
- ✻ 1300 Acres from Stow
- ✻ 1891 - Last Smith in town was Ben
- ✻ Ben of Ben Smith Dam?

ON THE TABLE...

☼ Wills

☼ Deeds

☼ Maps

☼ Photos

☼ 1922 Outline of Noah & Levi Houses,
Cider Mill, Schoolhouse, and Barn

The End

Questions?